

Construction starts in Warsaw for State Music School Complex No. 1

By Marc Quiquerez

On April 16, 2018, the Cornerstone Ceremony was held on the site of the new headquarter of the State Music School Complex Nr 1 (Zespół Szkół Muzycznych Nr 1, or ZPSM Nr 1) in Poland's capital Warsaw. The new facility will be located in a refurbished neo Gothic red brick building and augmented with a brand-new extension on the adjacent plot. The extension will include a 320-seat concert hall destined for the school's student symphony orchestra and guest performances.

The architectural design competition was held in the summer of 2015. Polish architect Tomasz Konior ([Konior Studio](#)) invited Nagata Acoustics to join his team and provide room acoustical consulting services for the new concert hall, with the ambition to continue our successful collaboration after the opening of NOSPR Katowice concert hall the previous year (as reported in our November 2014 newsletter). The project was awarded to the team in September 2015, and design phases extended through 2016.

Behind the renovated early 20th century building, the new construction consists of a U-shaped structure forming a square courtyard where the concert hall will be housed in a round stand-alone edifice, approximately 24m in diameter. One of the key functions of the space will be to teach students (aged 6 to 18) about on-stage and ensemble performance through actual experiences. It was therefore designed with the continued intention to create a friendly and comfortable environment for young performers, with a close connection with the audience.

Inside the hall, the circular outline of the footprint is explicitly broken down and reversed to expose only convex surfaces in order to prevent sound focusing and favor diffusion. In doing so, a large empty volume was created between the main concrete structure and the back of the tall sail-like reflectors which drape the main walls up to the 14m-high ceiling. The design of the hall then proceeded to reclaim this volume by carving openings between and above the sails. In doing so, the effective room air volume of the hall was increased, with the outer volume of-



Figure 1: Warsaw State Music School Complex Nr 1 Construction Site (2018.05.08) ©Konior Studio

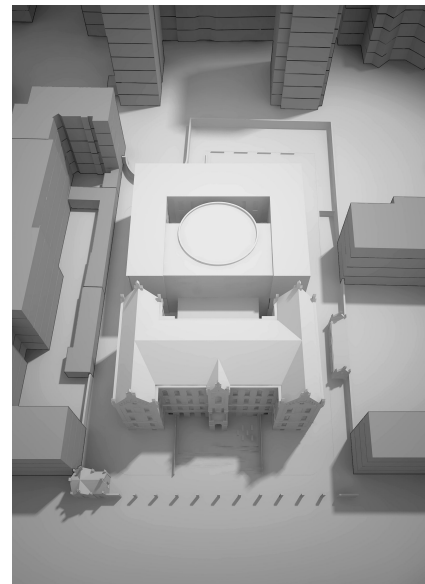

Figure 2: Model of Site and Building
©Konior Studio

fering the opportunity to enhance the reverberance of the space while still allowing for a control of the reverberant tail by the addition of absorptive materials without impacting the visual and acoustical aspect of reflective surfaces around the audience.

While most of the audience is conventionally seated in front of the stage in a single tier amphitheater with a steep rake, a terrace of two rows adds seats to the sides and behind the stage to enhance the compactness of the hall and the proximity between listeners and performers. The stage is dimensioned to accommodate up to 80 performers and equipped with semi-circular orchestra risers. Construction began on site in late 2017 and completion is scheduled for September 2019.

More information on the project: School Website (in Polish): <https://www.miodowa.edu.pl/> Konior Studio Website: <https://koniorstudio.pl/>



Figure 3: Concert Hall Interior (Rendering)
©Konior Studio